

# Computer Zero (0)

By Wensdy Whitehead

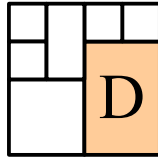

Recommended Paper: thin 2x3" -6x9" (50x75mm - 150x225mm) paper-backed foil 2:3 rectangle size D.

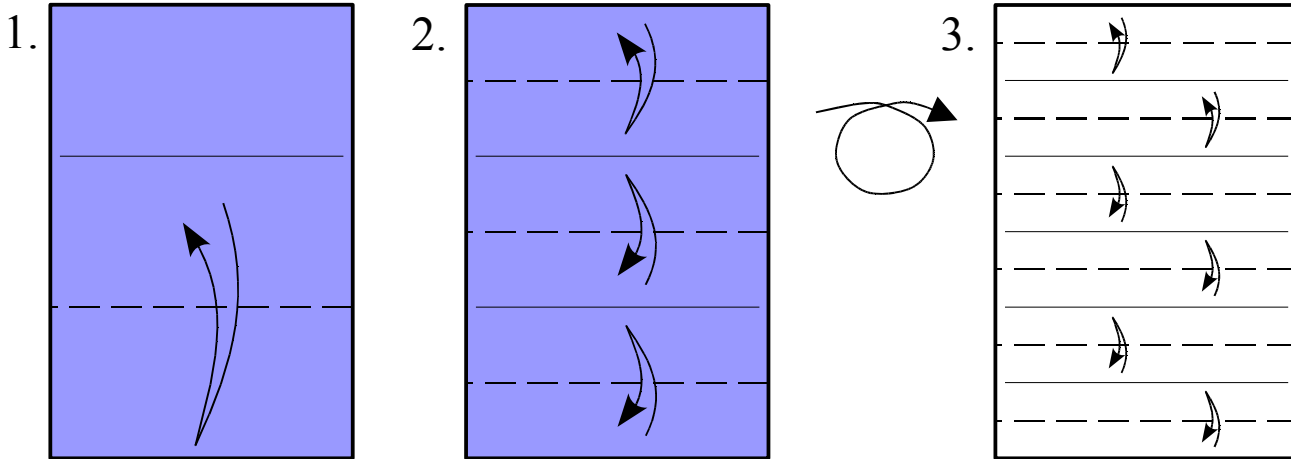

If you created size D from size A with book and cupboard folds, you already have one third mark; just fold to it for the other third.

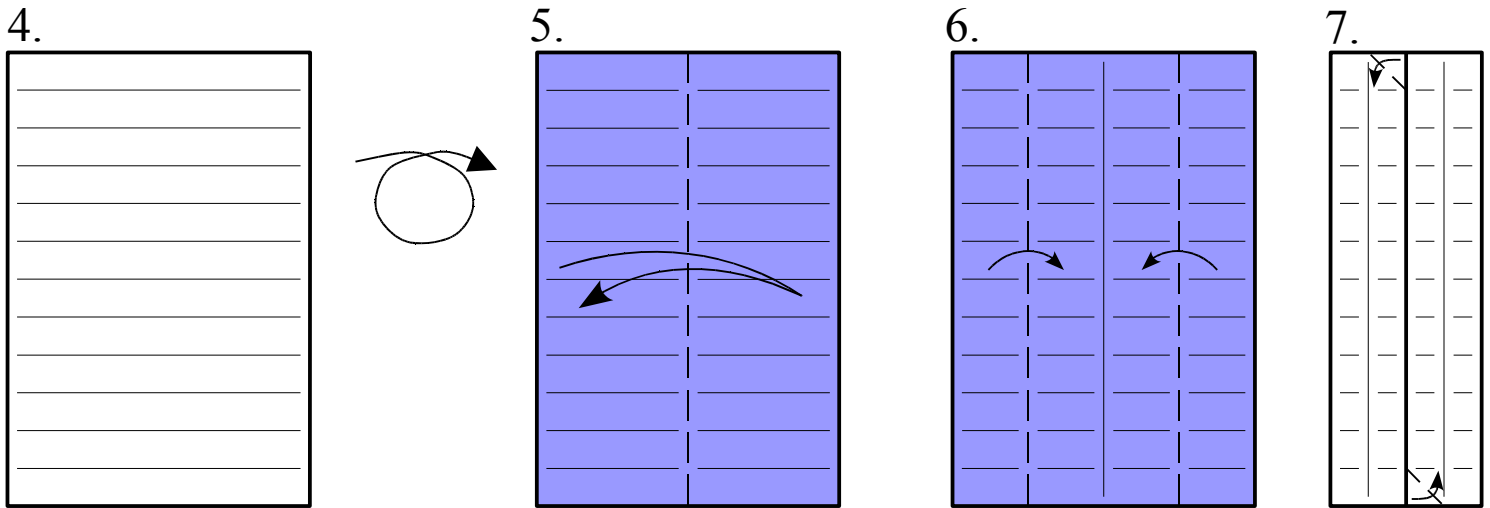

Dog-ear.

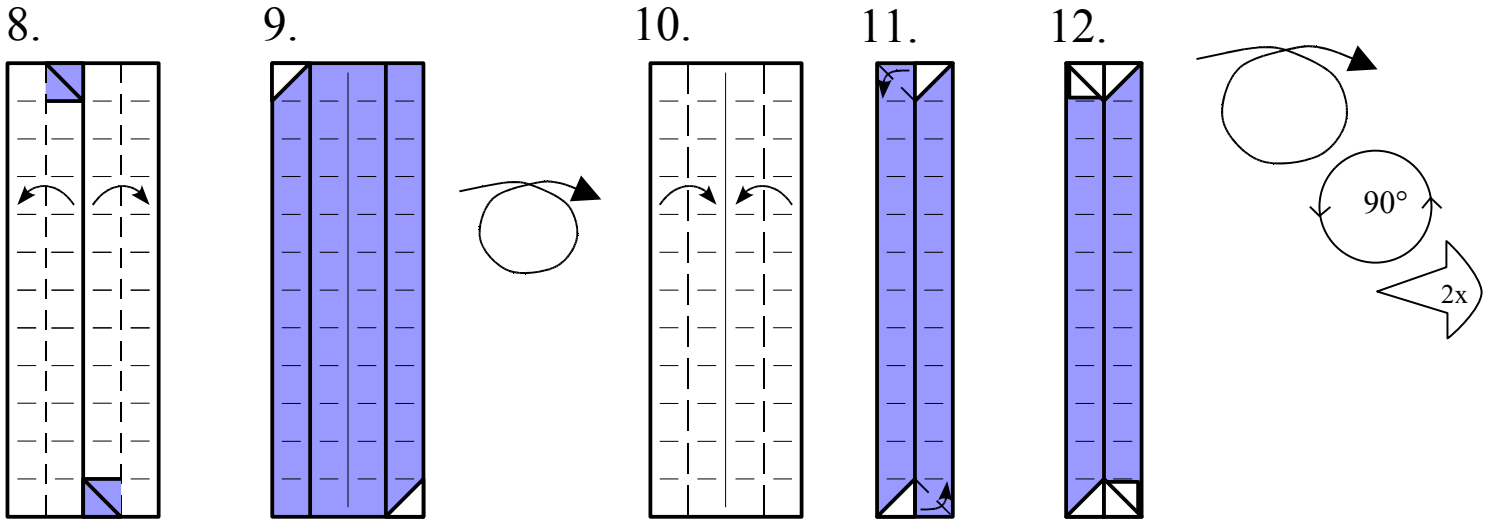

Dog-ear. Leave a fudge factor.

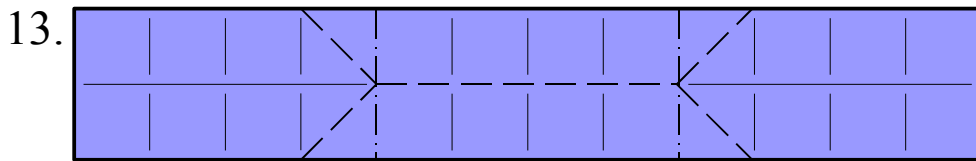

13. Barbell fold. (Conjoined rabbit-ears.) Model becomes 3D.

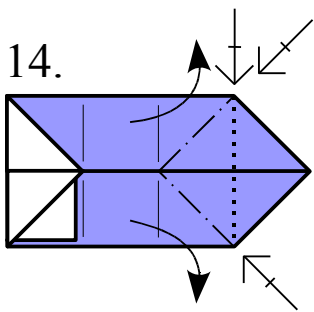

14. Shovel fold. (Pick up raw and folded edges on the center line and open, passing through a shape that looks like the scoop of a shovel. If you turn the model over while doing this, be sure to turn it back for the next step. These diagrams hold the model in place while the shovel folds flip back and forth.) Repeat behind.

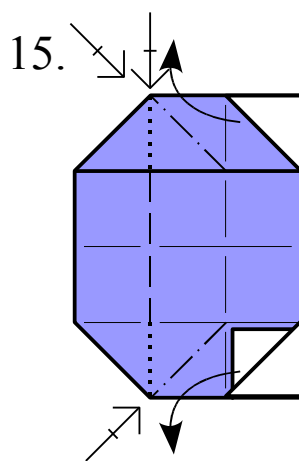

15. Shovel fold. Repeat behind.

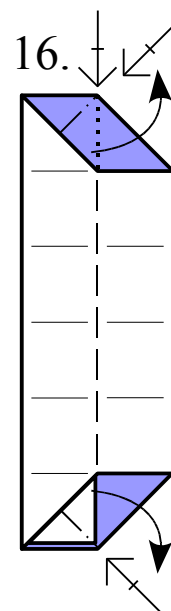

16. Shovel fold. Repeat behind.

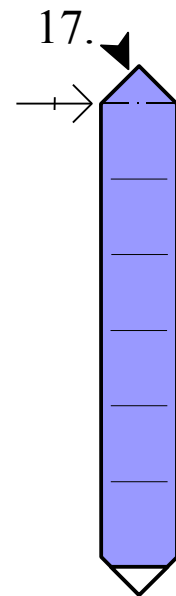

17. Inside-reverse fold. Repeat behind.

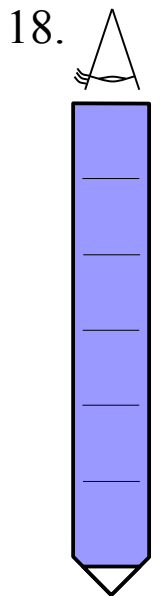

18. New view.

